

Models VORTEX 75 SS 304
VORTEX 100 SS 304
VORTEX 150 SS 304

Description High quality pump suitable to pump slightly corrosive dirty water. Its most frequent applications are in domestic installations and in small industrial plants.

Pumped fluid Slightly corrosive dirty water
Application
Max Density 1100 kg/m³
Temperature range 0-40 °C 32-104 °F
pH range 6-13 pH



Performance

Models		Head (m)					
		2	4	6	8	10	12
		Capacity					
VORTEX 75 SS 304	l/min	220	170	103	25		
	m ³ /h	13,2	10,2	6,2	1,5		
	l/s	3,67	2,83	1,72	0,42		
VORTEX 100 SS 304	l/min	265	218	160	95	5	
	m ³ /h	15,9	13,1	9,6	5,7	0,3	
	l/s	4,42	3,63	2,67	1,58	0,08	
VORTEX 150 SS 304	l/min	380	338	280	205	120	36
	m ³ /h	22,8	20,3	16,8	12,3	7,2	2,2
	l/s	6,33	5,63	4,67	3,42	2,00	0,60

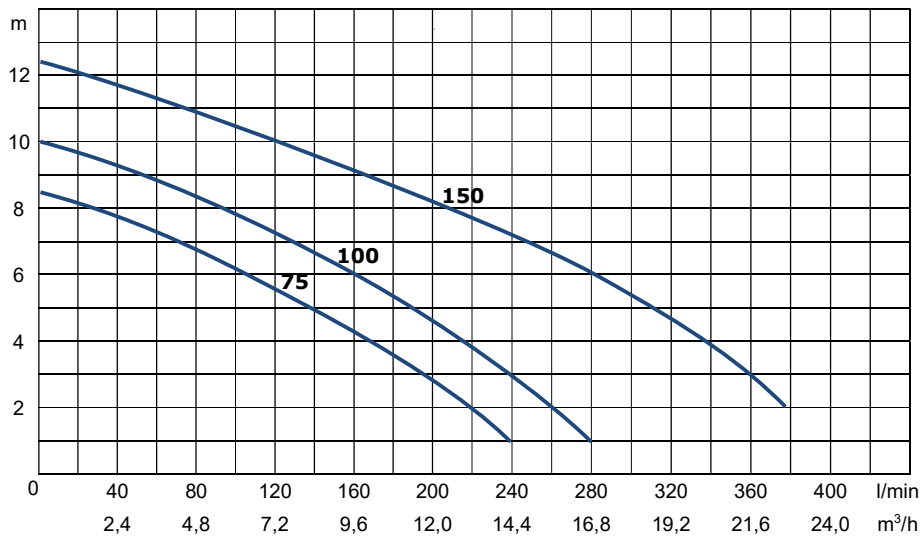

Hydraulic

<i>Impeller type</i>	Back open impeller "vortex" type
<i>Outlet</i>	VORTEX 75 SS 304 + VORTEX 100 SS 304 (vs. 1"1/2): 1"1/2 – horizontal, threaded BSP female VORTEX 100 SS 304 (vs. 2") + VORTEX 150 SS 304: 2" – horizontal, threaded BSP female
<i>Free passage</i>	38 mm
<i>Max head</i>	VORTEX 75 SS 304: 8,5m (0.8 bar) VORTEX 100 SS 304: 10m (1.0 bar) VORTEX 150 SS 304: 12,5m (1.2 bar)
<i>Min head</i>	VORTEX 75 SS 304 + VORTEX 100 SS 304: 1 m VORTEX 150 SS 304: 2 m
<i>Max capacity</i>	VORTEX 75 SS 304: 240 l/min VORTEX 100 SS 304: 280 l/min VORTEX 150 SS 304: 380 l/min
<i>Min suction level</i>	115 mm

Electric characteristics

Models	Power (P ₂)		rpm	Voltage	ph	I _N	Built-in float-switch	Capacitor
	HP	kW						
VORTEX 75 SS 304 MG	0.75	0.55	2850	230	1~	4,2	YES	16
VORTEX 100 SS 304 M (1"1/2)	1.0	0.75	2850	230	1~	5,9	NO	25
VORTEX 100 SS 304 MG (1"1/2)							YES	
VORTEX 100 SS 304 M (2")							NO	
VORTEX 100 SS 304 MG (2")							YES	
VORTEX 150 SS 304 MG	1.5	1.1	2850	230	1~	7,0	YES	30
VORTEX 150 SS 304 T				400			3~	

Technical characteristics

<i>IP</i>	68
<i>Sealing</i>	Double mechanical seal in oil bath
<i>Max. immersion</i>	5 meters (with 10 meters cable)
<i>Protective coating</i>	None
<i>Sound pressure level</i>	< 70dB

Components & Materials

<i>Cable</i>	Neoprene H07RNF, length 10 meters. 3G1 with molded SHUKO plug for single-phase; 4G1 with free ends for three-phase
<i>Impeller</i>	Stainless steel AISI 304 1.4301 (A2)
<i>Discharge body</i>	Stainless steel AISI 304 1.4301 (A2)
<i>Motor case</i>	Stainless steel AISI 304 1.4301 (A2)
<i>Pump cover</i>	Stainless steel AISI 304 1.4301 (A2)
<i>Motor shaft</i>	Stainless steel AISI 304 1.4301 (A2)
<i>Screws</i>	Stainless steel AISI 304 1.4301 (A2)
<i>Mechanical seal</i>	Lower: Silicon carbide / Silicon carbide / NBR / AISI 304 Upper: Silicon carbide / Graphite / NBR / AISI 304
<i>Kit o-ring</i>	NBR
<i>Ball bearings</i>	Lower: 6204 ZZ, upper: 6202 ZZ
<i>Oil</i>	Dielectric, not polluting, not toxic

Motor characteristics

<i>Type of motor</i>	Hard-duty squirrel cage motor
<i>Start type</i>	DOL (Direct On Line)
<i>Protection</i>	Automatic reset built-in thermal protection (for single-phase voltage); by a magnetothermic switch by the user for three-phase voltage (see optional section for electric boards)
<i>Insulation class</i>	Class F
<i>Nos. of poles</i>	2
<i>Service type</i>	S1 (with pump completely immersed into pumped fluid)
<i>Cooling</i>	Ensured by the immersion of the pump into the fluid

Optional available

<i>Coupling foot</i>	Coupling foot model 2" or 1"1/2 in cast-iron
<i>Hose connection</i>	- 90° elbow hose connection in brass, 3 pieces, 1"1/2 x DN45mm or 2" x DN50mm - 90° elbow in stainless steel AISI 316, 1"1/2M x 1"1/2 F or 2"M x 2"F
<i>Electric board</i>	F5-0.5/3-1 for single-phase, F6-0.5/10-3 for three-phase
<i>No return valve</i>	- Professional no-return ball check valve 1"1/2 or 2" in cast-iron, NBR ball
<i>Separated float switch</i>	10 meters cable or 20 meters cable float-switch to be connected to an electric board F5-0.5/3-1 o F6-0.5/10-3
<i>Anods</i>	To avoid corrosion by galvanic currents

Dimensions & weight

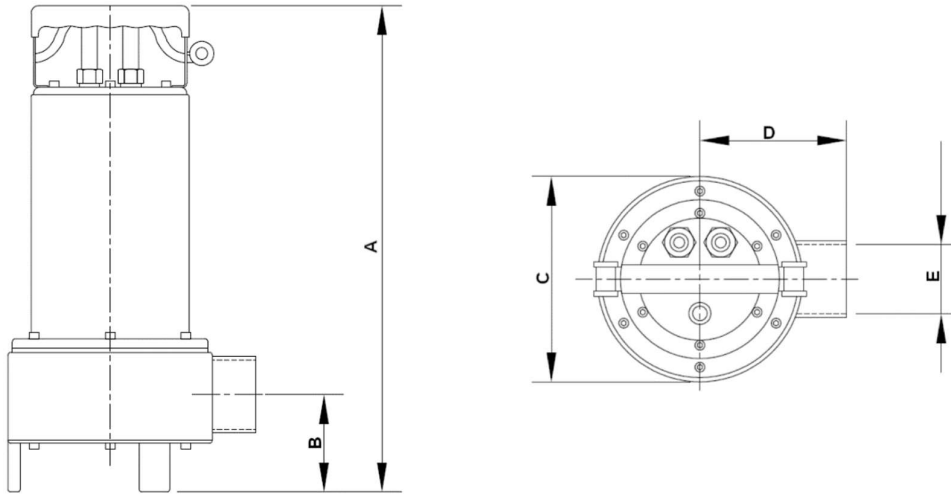

Models	Dimensions (mm)					Carton box	Weight kg	Pumps per layer on EPAL
	A	B	C	D	E			
VORTEX 75 SS 304	370	80	168	109	1"1/2	230x200xH470	13	20
VORTEX 100 SS 304 (1"1/2)	400	80	168	109	1"1/2	230x200xH470	14	
VORTEX 100 SS 304 (2")				120	2"	230x200xH470	14	
VORTEX 150 SS 304	400	80	168	120	2"	230x200xH470	15	